



Manual ball valves, plastic body, 3/2-Way

- For aggressive & pure process media
- Full bore to achieve high flow rates
- Floating ball, double stem seal
- Long service life

Type 2657 can be combined with...



Type 2658

Valve with PA actuator & prox switch



Pneumatic Actuator polyamide for chemical areas



Type 2050 & pilot
Vertical actuator, quarter turn type



Pneumatic Actuator rotary vane type, double acting

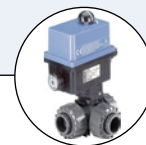

Type 2659

Valve with electric actuator

3/2-way ball valves in plastic (PVC standard, others on request) for manual flow control. Available in various body versions and materials to suit various applications.

Valves are low weight and compact for easy handling. Radial installation and removal.

A modular ISO mounting pad bracket is available for Bürkert PVC ball valves to allow direct mount of actuators and top works.

Special feature

The ball valves are equipped with the patented Dual Block® Technology. This system serves as a safety device for the union nuts. It prevents these separating during operation.

Applications

- Aggressive processes
- Chemical environments
- Water treatment
- High volume dosing
- High viscosity media

Technical data

Body material	PVC-U, PP (PVDF, PVC-C, ABS on request)
Seal material	PTFE/EPDM (standard line), PTFE/FKM
Media temperature	(see diagrams below)
PVC-U	0 to +60°C
PP	10 to +80°C
PVDF	0 to +120°C
Port connection	
PVC-U (standard line)	True union (solvent)
PP, PVDF	Fusion spigot
Operating pressure	
3/2-Way Valves	0 - 16bar

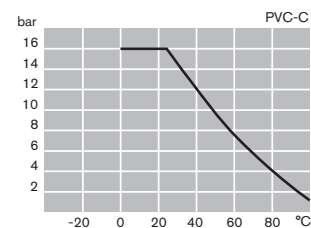
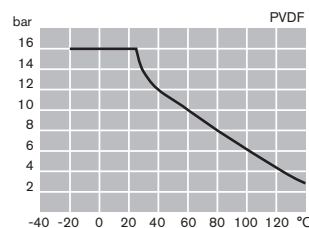
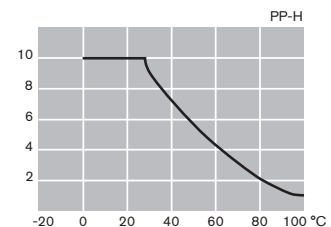
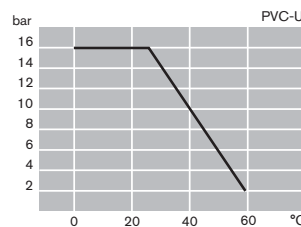

Materials

No.	Part	Material
1	Insert tool	PVC
2	Handle	PVC
3	Stem O-ring	EPDM-FPM
4	Stem	PVC
5	Ball seat	PTFE
6	Ball	PVC
7	Body	PVC
8	Support O-ring for ball seat	EPDM-FPM
9	Radial seal O-ring	EPDM-FPM
10	Socket seal O-ring	EPDM-FPM
11	Support for ball seat	PVC
12	End connector	PVC
13	Union nut	PVC
14	Blocking button	POM
15	Stop ring	PVC

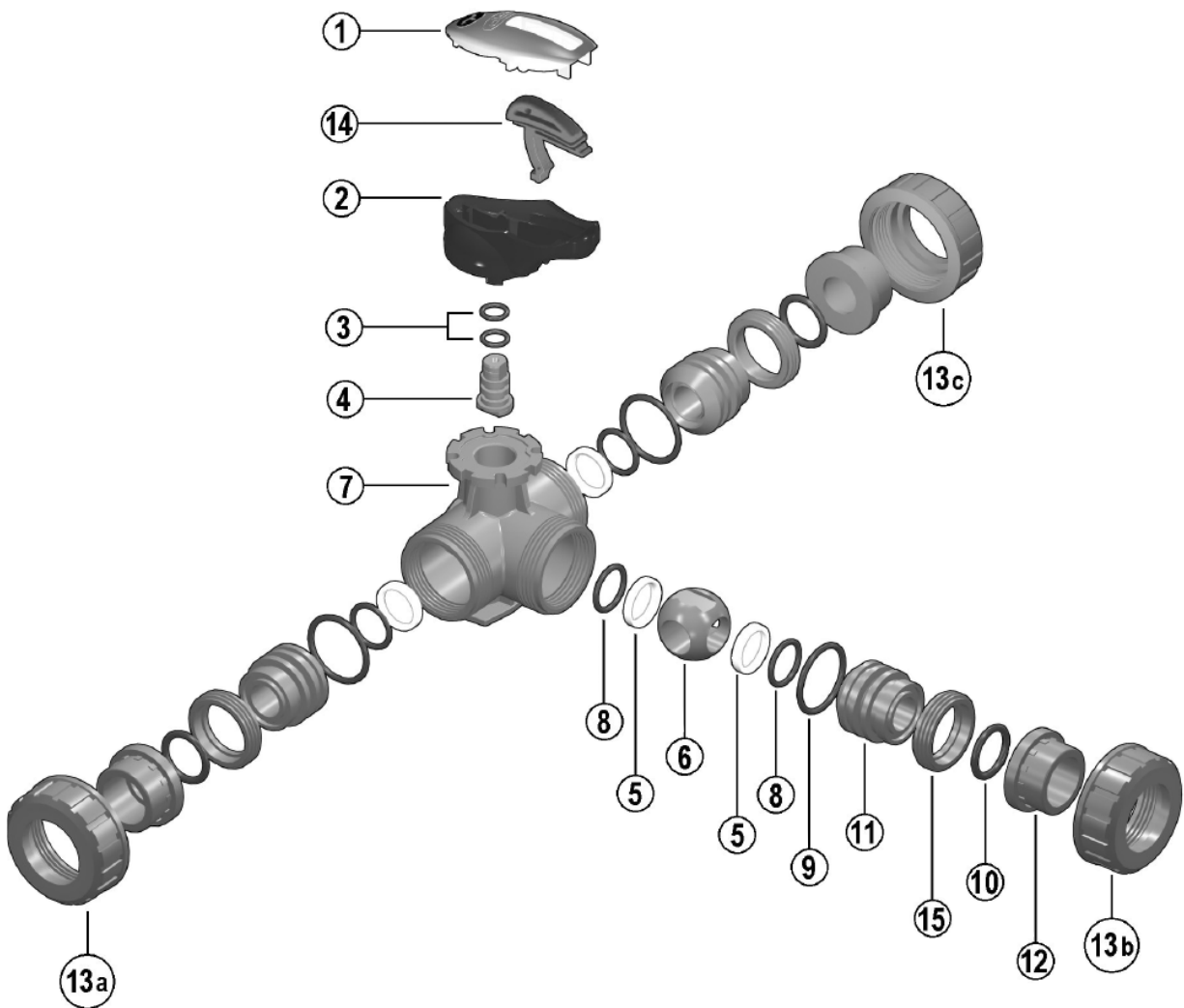

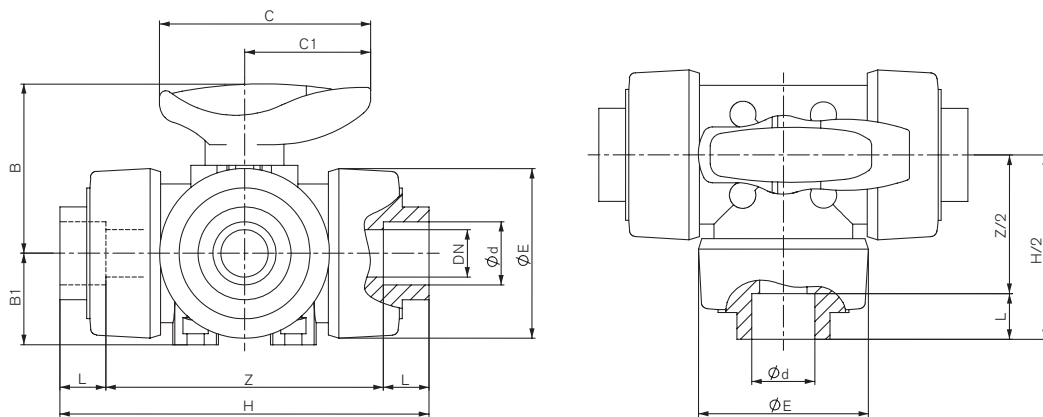

Dimensions [mm]



Ød	DN	L	Z	H	ØE	B	B1	C	C1	Weight [g]
16	10	14	90	118	54	54	29	67	40	310
20	15	16	86	118	54	54	29	67	40	310
25	20	19	107	145	65	65	34.5	85	49	550
32	25	22	116	160	73	69.5	39	85	49	790
40	32	26	136.5	188.5	86	82.5	46	108	64	1275
50	40	31	157	219	98	89	52	108	64	1660
63	50	38	190.5	266.5	122	108	62	134	76	2800

Ordering chart for valves (other versions on request)

3/2 Way manual ball valves with PTFE/EPDM seal (standard range) & FKM seal

	Switched position	Orifice [mm]	Port connection Ø	Kv water [m³/h]	Pressure range [bar]	ID No* [EPDM Seal]	ID No [FKM Seal]
	T port	10	3/8"	1.5	0-16	209890	186022
		15	1/2"	2.1	0-16	209891 [AU55015]	186023
		20	3/4"	5.7	0-16	209892 [AU55016]	186024
		25	1"	8.4	0-16	209893 [AU55017]	186025
		32	1 1/4"	16.2	0-16	209894 [AU55018]	186026
		40	1 1/2"	19.8	0-16	209895 [AU55019]	186027
		50	2"	37.2	0-10	209896 [AU55020]	186028
	L Port	10	3/8"	2.8	0-16	209897	186015
		15	1/2"	4.3	0-16	209897 [AU55009]	186016
		20	3/4"	9	0-16	209898 [AU55010]	186017
		25	1"	15.9	0-16	209899 [AU55011]	186018
		32	1 1/4"	28.5	0-16	209900 [AU55012]	186019
		40	1 1/2"	37.2	0-16	202689 [AU55013]	186020
		50	2"	67.2	0-10	209901 [AU55014]	186021

* Old IDs shown in square brackets; transitioning to part numbers shown at left of column

i Further versions on request